

# 06

## PNEUMATIC MULTI-CONNECTOR TUBE PANEL

---

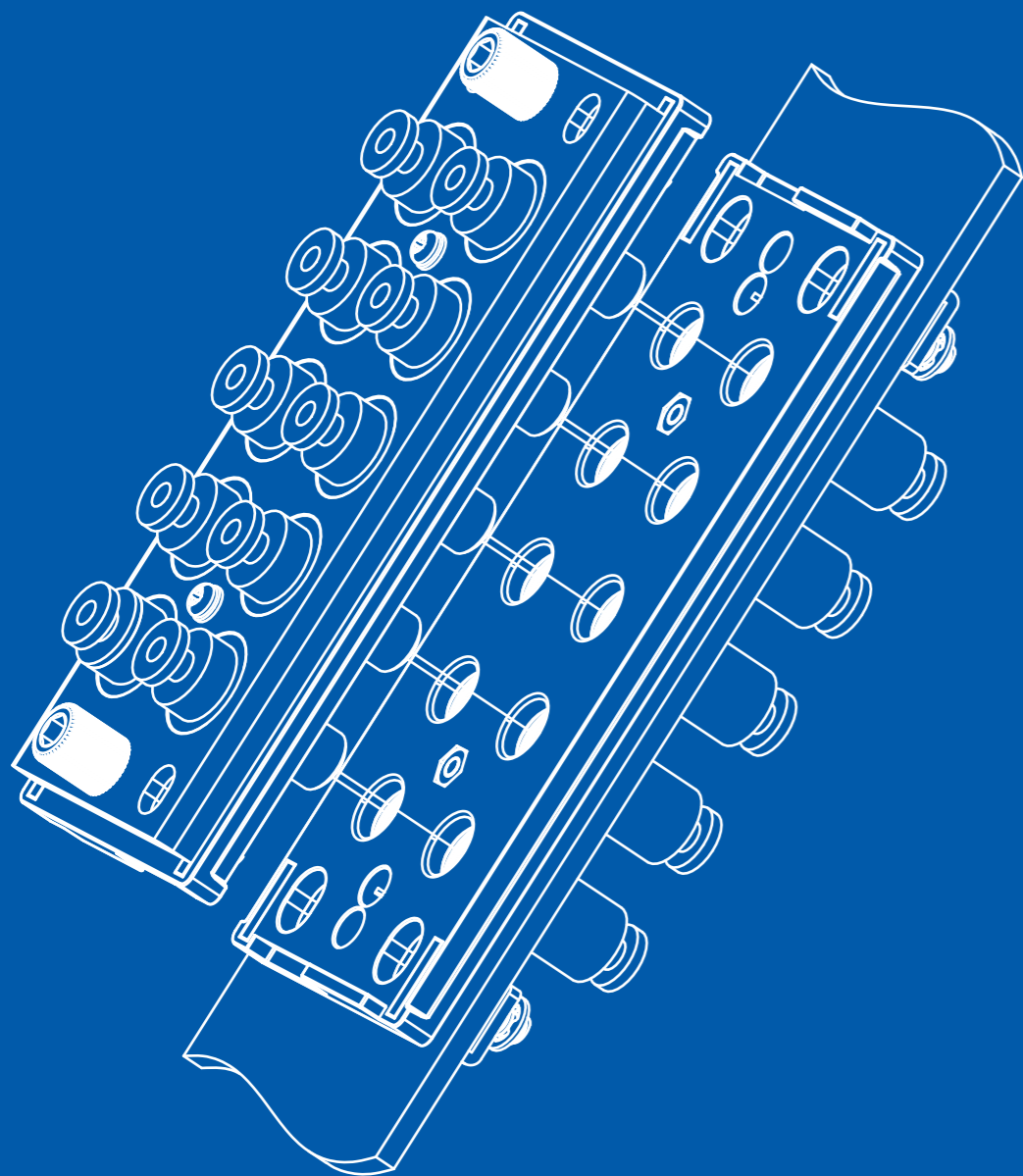

**FNS**<sup>®</sup>

PNEUMATIC MULTI-CONNECTOR TUBE PANEL

---

### **6.1** KDM connecting pipes: 10, 20

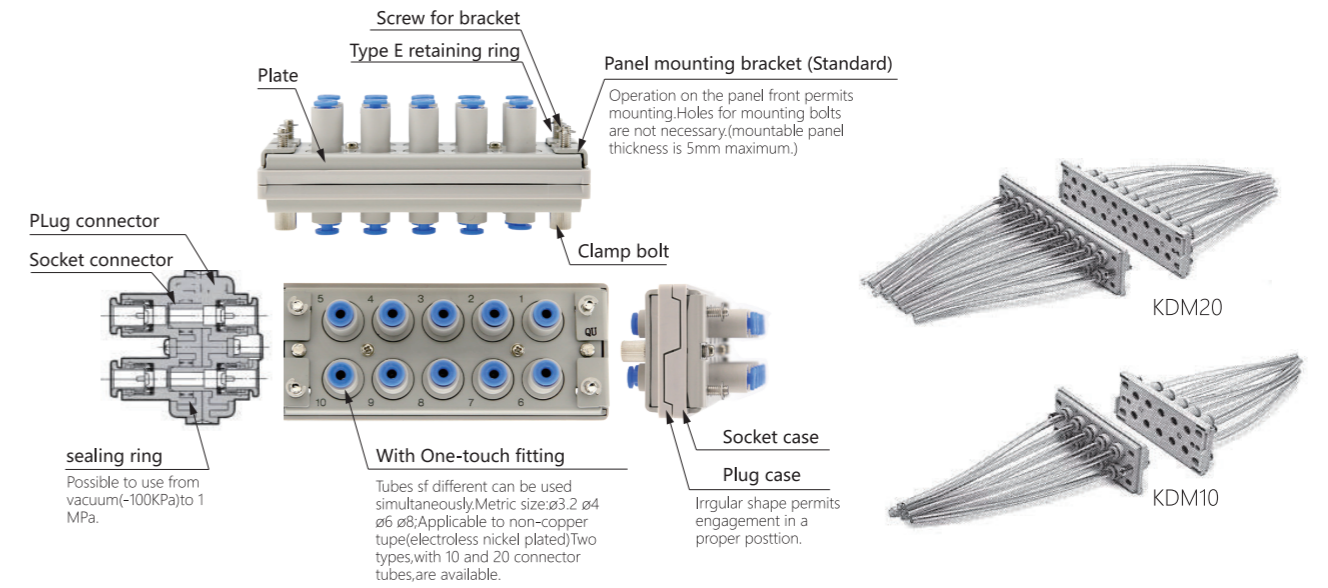
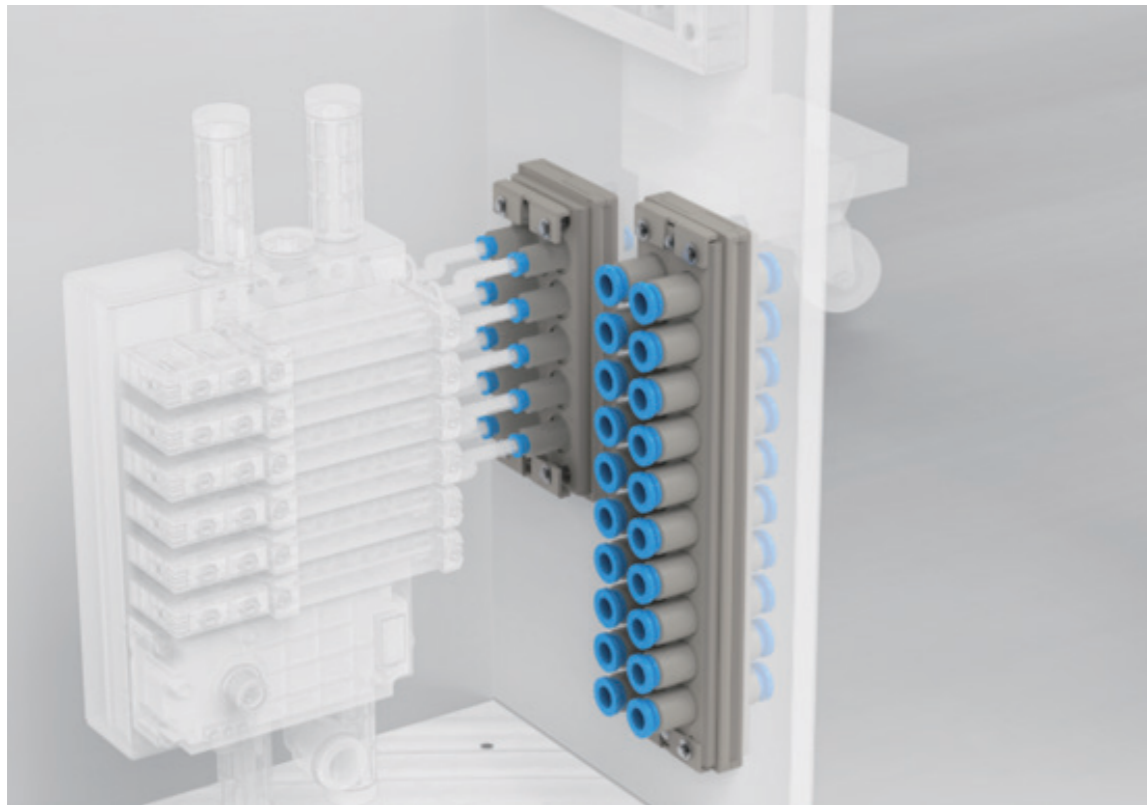

| Suitable for tube material |                                 |
|----------------------------|---------------------------------|
| - Tube material            | Nylon, soft nylon, polyurethane |
| - Tube material            | ø4,ø6,ø8                        |

| Specification                               |                          |
|---|--------------------------|
| - Use fluid                                 | Air                      |
| - Maximum working pressure                  | 1.0MPa                   |
| - Use vacuum pressure                       | -100kPa                  |
| - Pressure test pressure                    | 1.5MPa                   |
| - Ambient temperature and fluid temperature | -5~60°C(When not frozen) |

The gas/electric quick change module is convenient for separate handling of panels or mechanical devices and replacement of spare units

- ◆ Installation space is greatly reduced  
The installation space is much more compact than using straight through pipes for installation with multiple panels.
- ◆ Fast assembly and disassembly of joints  
Multiple pipes can be assembled and disassembled together, and the pipes will not be mistakenly arranged, and the installation time is greatly reduced.
- ◆ Fast tube connection  
Due to the quick-change connector, the piping work hours are greatly reduced.

| Tube outer diameter | NO.of connecting pipes             | Part number | Ordering code |
|---------------------|------------------------------------|-------------|---------------|
| ø4                  | NO.of connecting pipes (10 pieces) | KDM10-04    | 8A1021        |
|                     | NO.of connecting pipes (20 pieces) | KDM20-04    | 8A2021        |
| ø6                  | NO.of connecting pipes (10 pieces) | KDM10-06    | 8A1041        |
|                     | NO.of connecting pipes (20 pieces) | KDM20-06    | 8A2041        |
| ø8                  | NO.of connecting pipes (10 pieces) | KDM10-08    | 8A1061        |
|                     | NO.of connecting pipes (20 pieces) | KDM20-08    | 8A2061        |

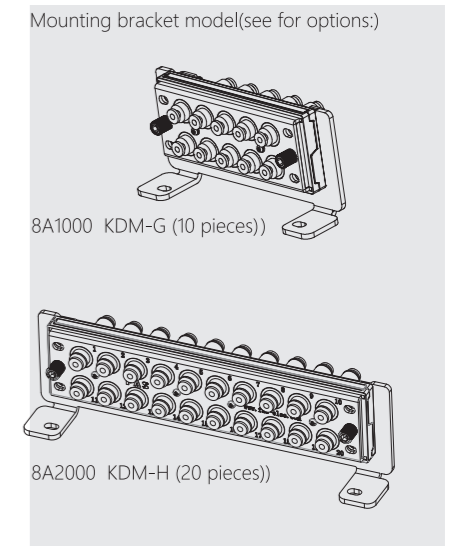

# Gas/electric docking pane

KDM connecting pipes: 10, 20

## Material of main parts

|  |   |
|--|---|
| Plug case, socket case   | POM   |
| Plate, bracket   | SPCC plated   |
| Plug connector/Socket connector                                  |   |
| - Body   | PBT.C3604BD electroless nickel plating (In the case of φ8)          |
| - Chuck  | SUS304  |
| - Guide  | SUS304, C3604BD electroless nickel plating, POM (In the case of φ8) |
| - Collet, release button   | POM   |
| - Guide  | NBR   |
| Clamp bolt, screw for bracket, cross-recessed head machine screw | SWRM nickel plated  |
| Type E retaining ring SUS304 clamp bolt                          | SUS304  |

## Part number

| Tube outer diameter | Number of connecting pipes | Plug side type | Socket side type | Color of release button |
|---------------------|----------------------------|----------------|------------------|-------------------------|
| φ4                  | 10                         | KDM10P-04      | KDM10S-04        | Blue                    |
|                     | 20                         | KDM20P-04      | KDM20S-04        | Blue                    |
| φ6                  | 10                         | KDM10P-06      | KDM10S-06        | Blue                    |
|                     | 20                         | KDM20P-06      | KDM20S-06        | Blue                    |
| φ8                  | 10                         | KDM10P-08      | KDM10S-08        | Blue                    |
|                     | 20                         | KDM20P-08      | KDM20S-08        | Blue                    |

## Caution

### Separation

Loosen the fastening screw, and the plug side is separated from the socket side.

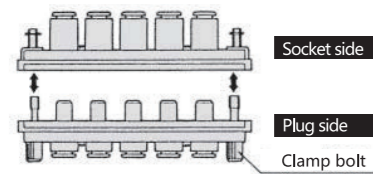

### Connection

Put together the irregular connect the plug case to the socket. After tightening the clamp bolt by hand, tighten it further with allen wrench flats:4.

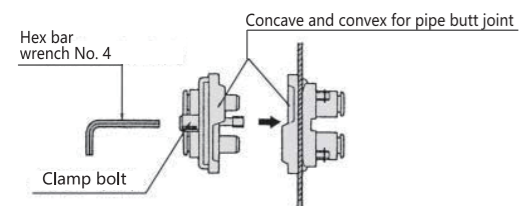

### Panel mounting

(1) Use a Phillips screwdriver (JS No. 2) to loosen the 4 screws on the side of the socket until the bracket touches the upper elastic retaining ring.

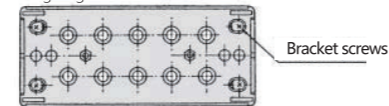

(2) Move the panel mounting bracket to the inside (Move the frame screw in the direction of the long hole) and install the connector on the panel mounting hole. (See panel mounting holes: Outline dimension drawing)

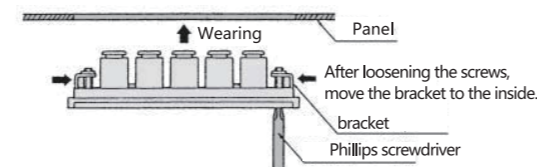

(3) After moving the bracket screws to the outside, tighten the screws with a Phillips screwdriver. Secure the socket cover.

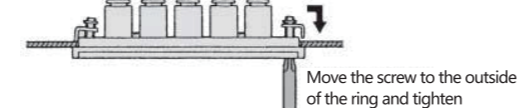

(4) Loosen the bracket screws until the bracket hits the upper elastic stop, then move the bracket to the inside to remove the connector from the faceplate.

# Gas/electric docking pane

## KDM 10 installation diagram and dimensions:

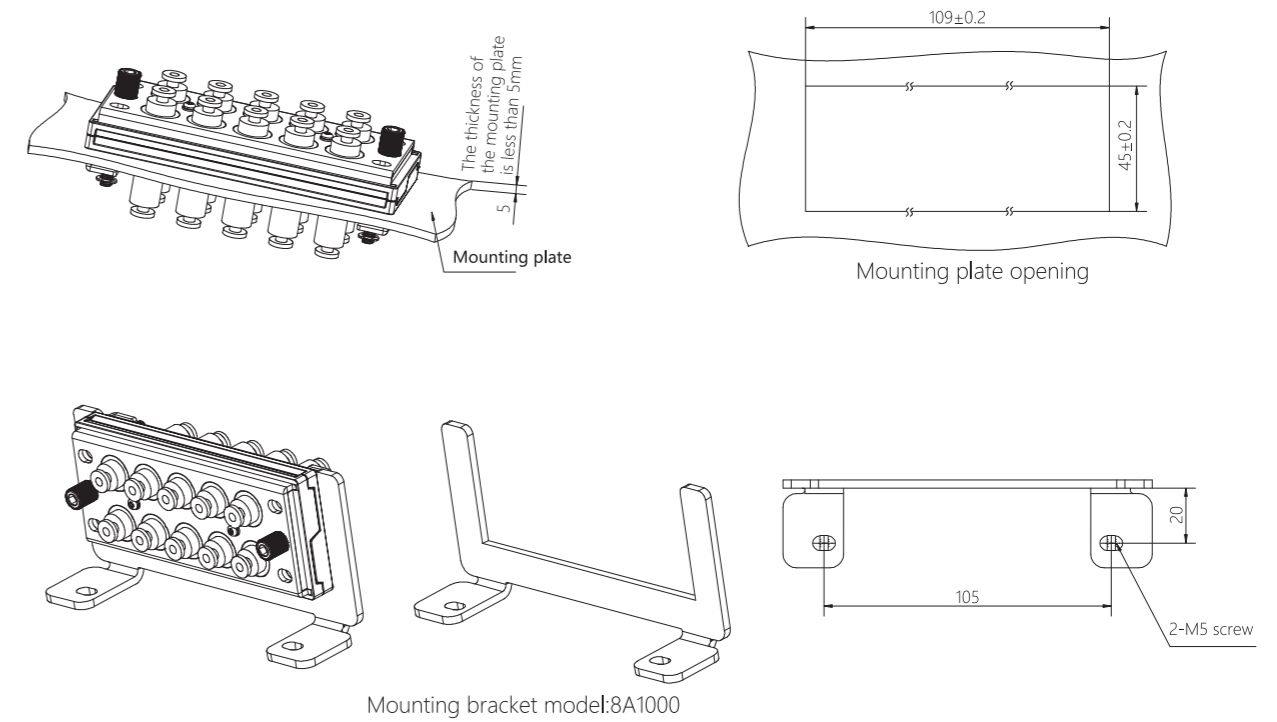

## KDM 20 installation diagram and dimensions:

